

# Model 8225 Electric Condenser

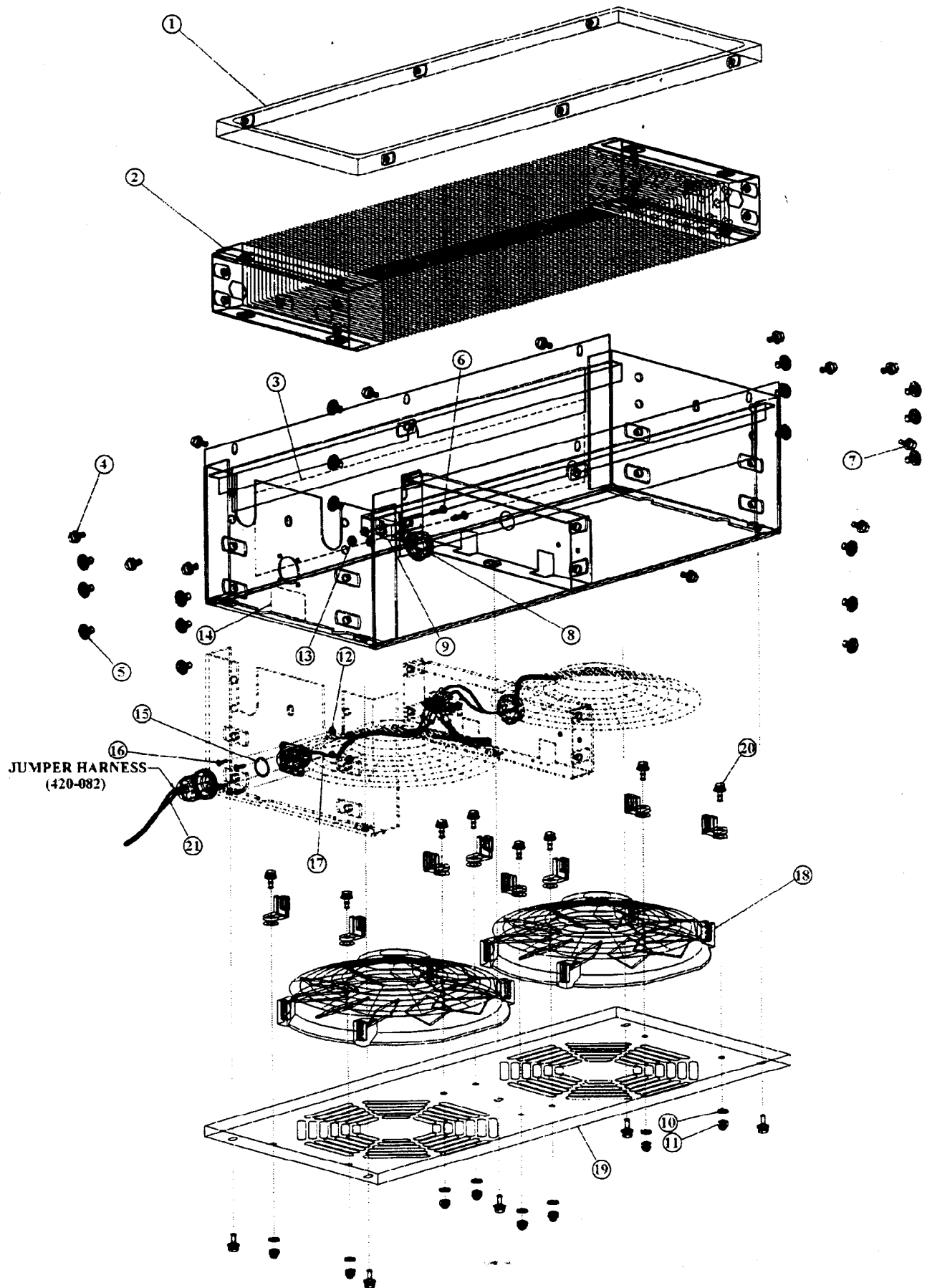

**Model - 8225 Electric Condenser**

<b>ITEM</b>	<b>QTY.</b>	<b>PART #</b>	<b>DESCRIPTION</b>
1.	1	202-164	Screen Weldment
2.	1	500-541	Coil Assembly
3.	1	400-472	Decal "Eagle" Clear / Black Letters
4.	4	300-726	HHCS Whizlock 5/16 NC X 1/2 ZP
5.	18	301-113	Truss Screw 5/16 NC (Nylon)
6.	2	300-904	10-32 X 3/4" Truss HD Slotted Screw
7.	13	300-491	HHCS Whizlock 1/4 NC X 1/2 ZP
8.	1	403-166	Grommet, Rubber 7/8" Hole
9.	1	400-450	Terminal Stud Block 10-32
10.	8	300-974	Washer, Lock Tooth Type 1/4"
11.	8	301-009	Nut, Acorn (Cap) 1/4-20 NC
12.	4	301-112	6-32 Locking Nut (Nylon Insert)
13.	3	300-861	10-32 NF Nut Keep
14a.	1	402-308	Decal "24 Volt"
14b.	1	402-307	Decal "12 Volt"
15.	1	404-973	Seal
16.	4	301-111	#6-32 X 1/2 Slotted RMHS
17.	1	420-081	Wire Harness Assembly (Internal)
18a.	2	450-451	Fan Assy. 9" Pusher 10" Blade 24V
18b.	2	450-452	Fan Assy. 9" Pusher 10" Blade 12V
19.	1	102-254	Top, E.C.
20.	8	300-492	HHCS Whizlock 1/4 NC X 3/4 ZP
21.	1	420-082	Wire Harness Assembly (External)